

TLM-1530HP

- > High power 4 Volt cell
- > No voltage delay
- > Long shelf life
- > End of life indication capability

Performance Data

(Typical values for batteries stored at +25 °C for one year)

System	Lithium Metal Oxide
Nominal voltage	4.0 V
Nominal capacity	240 mAh
Nominal current	20 mA
Max. continuous discharge current	2.5 A
Pulse current capability	6.5 A
Cell impedance	max. 175 mΩ
Anode surface area	160 cm ²
Lithium content	0.08 g
Weight	11 g
Volume	4.4 cm ³
Temperature range	-40 °C ... +85 °C



Discharge Capability at +25 °C

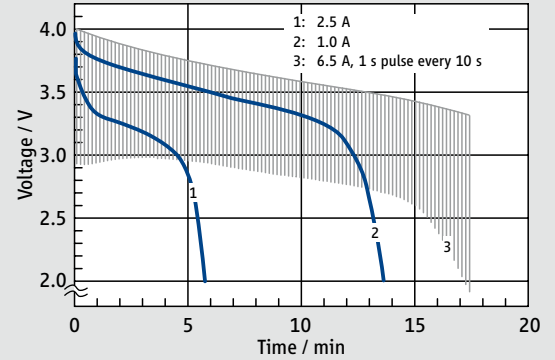

Temperature Behaviour

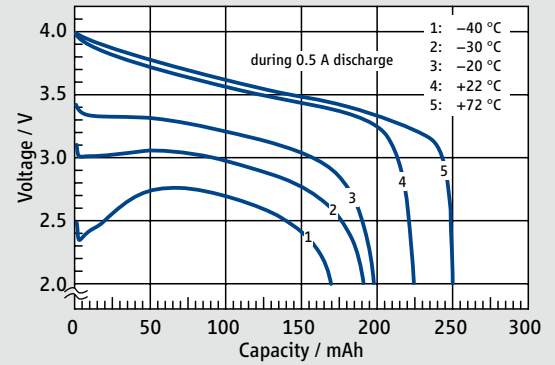

TLM-1530HP/S

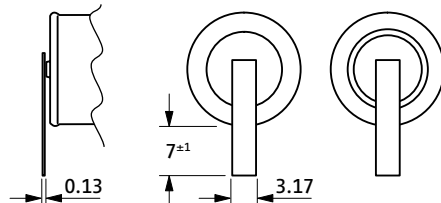
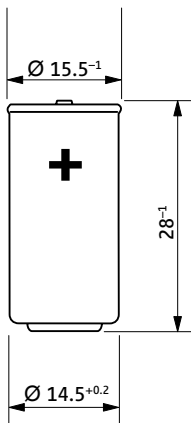

TLM-1530HP/T

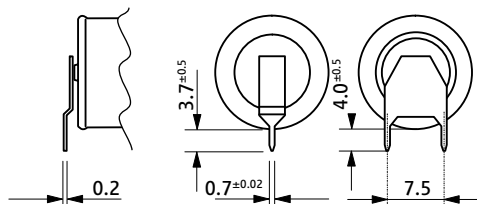

TLM-1530HP/TP

Available Terminations

Termination	Standard	Catalogue No.
TLM-1530HP/S	Standard	12 0 12531 02
TLM-1530HP/T	Tags	12 0 12532 02
TLM-1530HP/TP	Polarized tags	12 0 12537 02

WARNING:
Fire, explosion,
and severe burn hazard. Do
not charge, disassemble,
heat above 100 °C,
incinerate, or short circuit.

Any values given here are for informational purposes only. They also depend on actual conditions of use and are not warranties of future performance. Subject to change.

Ageing during Storage

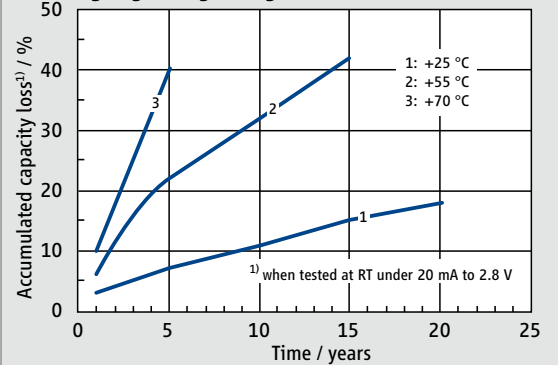

Voltage Curve

